

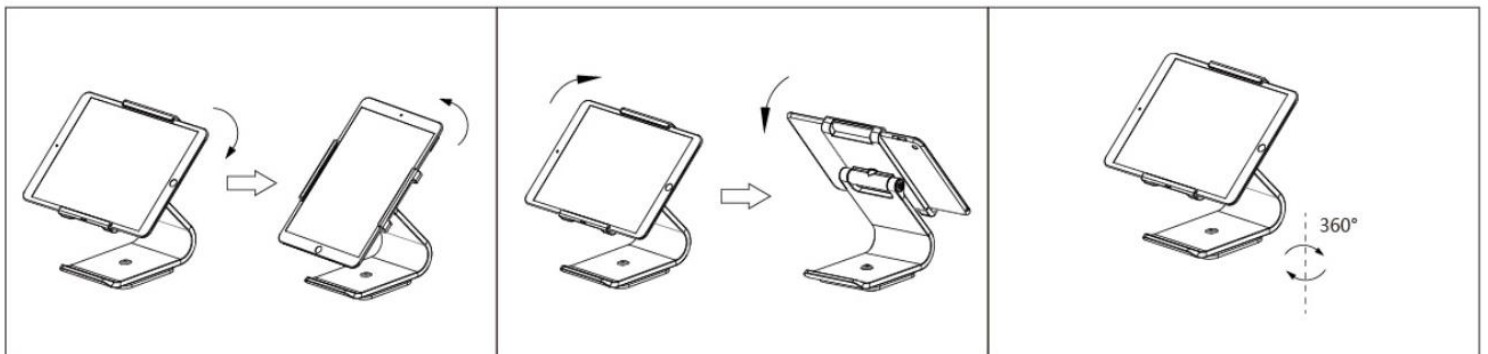

Information

Tablet Compatibility	iPad5/6, iPad Air 1/2, iPad Pro 9.7"
Dimensions (mm)	185×100×168
Dimensions (inch)	7.3×3.9×6.6
Net Weight	1.3kg
Material	Aluminium Alloy
Color	White
Customization	Color, Tablet enclosure

Product Usage



Assembly & Installation

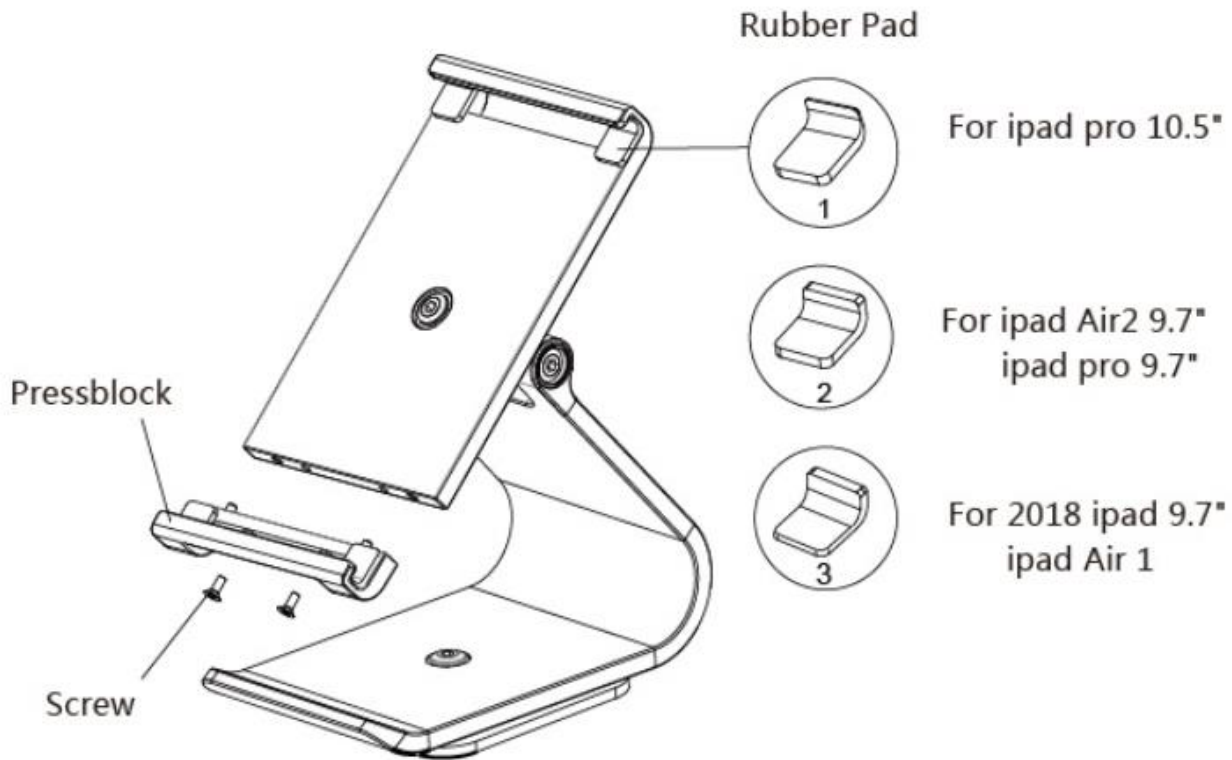

Mounting Options

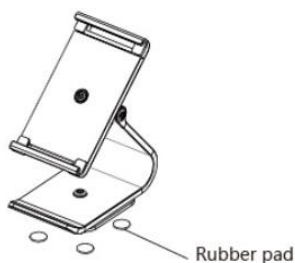

Option 1:

Stick four rubber pads onto the bottom of stand base directly To avoid the friction between the stand base and the working surface .

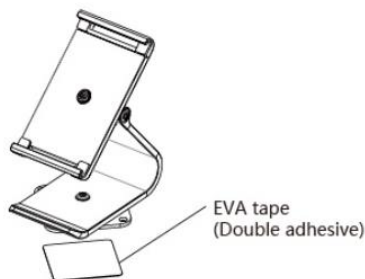

Option 2:

Stick two provided EVA tapes onto the stand base

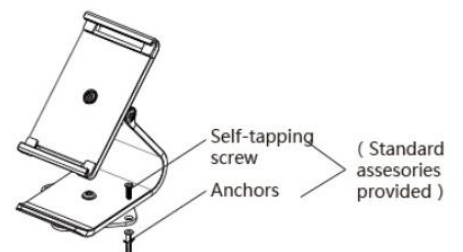

Option 3:

Drill holes on the table and screw the stand on the surface.